

UW-LA CROSSE

*uwla.edu*

1725 State St. | La Crosse, WI 54601



- Commuter Parking (C Lots)
- Resident Parking (R Lots)
- Motorcycle/Moped Parking
- Parking Pay Station

1/4 mile ↑

**PARKING**

**Load/Unload Equipment**

**NEW RAMP CONSTRUCTION**

- RESIDENCE HALLS**
- \*\*1 Angell Hall - C2
- \*\*2 Coate Hall - D2
- \*\*3 Drake Hall - C3
- \*4 Eagle Hall - E3
- \*\*5 Hutchison Hall - C2
- 6 Laux Hall - E6
- \*7 Reuter Hall - E6
- \*\*8 Sanford Hall - E6
- \*9 Wentz Hall - C3
- \*\*10 White Hall - D6
- OTHER FACILITIES**
- \*\*11 Archaeology Center - B5
- 12 Baseball/Softball Fields - G3
- \*13 Cartwright Center - A5
- \*14 Centennial Hall - B4**
- 15 Challenge & Ropes Course - F3
- \*16 Child Care Center - D4
- \*17 Cleary Alumni & Friends Center - E5
- \*18 Cowley Hall - C5
- \*19 Fieldhouse - C7
- \*20 Graff Main Hall - A5
- \*21 Health Science Center - C1
- 22 Heating Plant - B5
- 23 Hoeschler Tower - B4
- \*24 Lowe Center for the Arts - B3**
- \*25 Maintenance Building - G5
- \*\*26 Mitchell Hall - B6
- \*27 Morris Hall - A4
- \*28 Murphy Library - C4
- \*29 North Field Equipment Building - G4
- \*30 Parking Services - D5
- Police Services - D5
- \*31 Prairie Springs Science Center - C5
- \*32 Recreational Eagle Center - D3
- \*33 Roger Harring Stadium at Veterans Memorial Field Sports Complex - C6
- \*34 Soccer/Lacrosse Building - E7
- 35 Student Recreation Fields - G1
- \*36 Student Union - D5**
- 37 Veterans Memorial Field Sports Complex - D7
- 38 Veterans Memorial Monument - C6
- 39 West Campus Chiller Plant - C1
- \*\*40 Whitney Center - D2
- \*41 Wimberly Hall - D4
- \*42 Wing Technology Center - A4
- \*43 Wittich Hall - B5

\*Handicapped accessible  
\*\*Limited accessibility





**Murphy Library**

**Wentz Hall**

**Centennial Hall**

**Truman Lowe Center for the Arts**

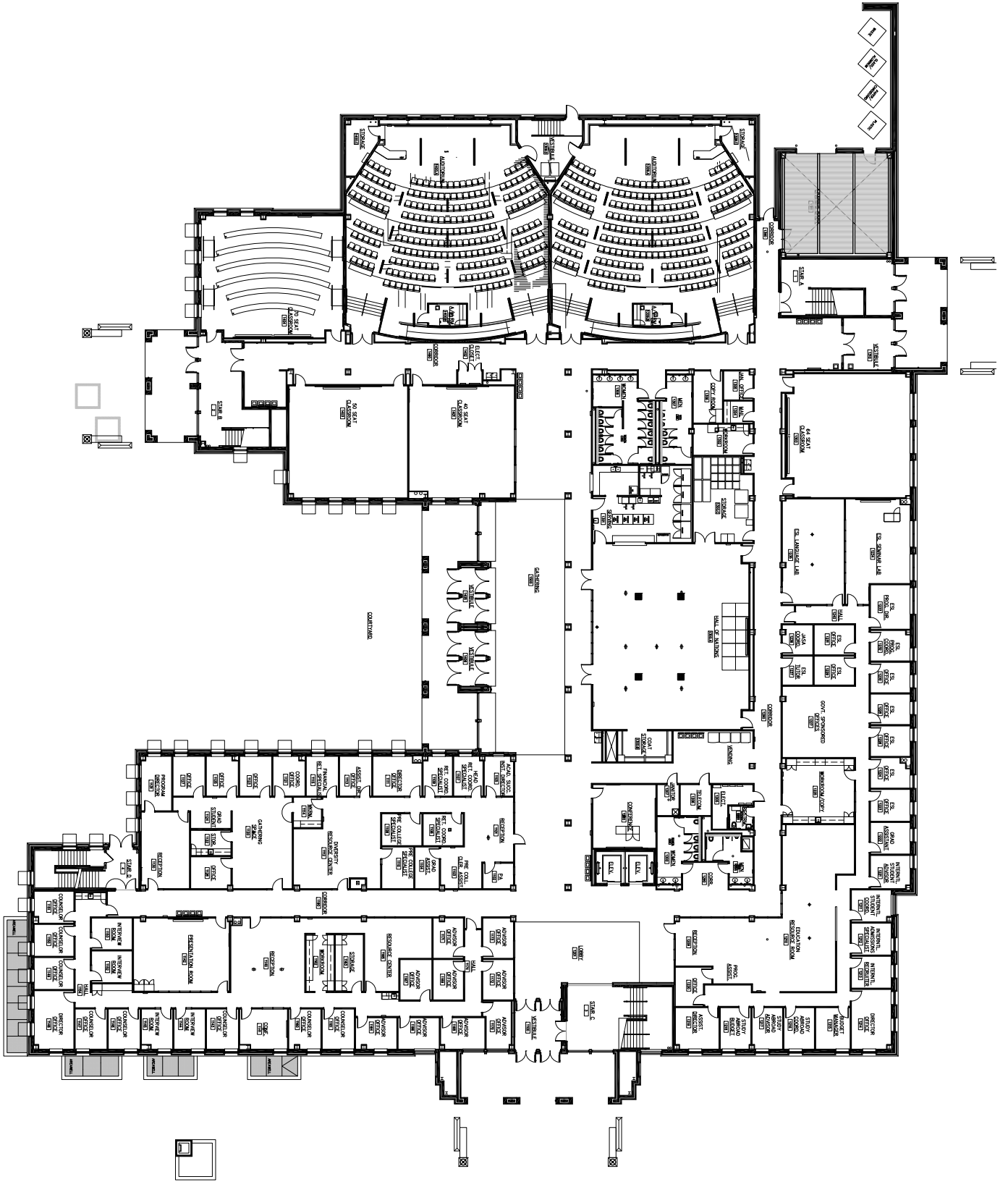

Project Title:  
**CENTENNIAL HALL**

Sheet Title:  
**FIRST FLOOR**

Revisions:

Drawn: **DRAWN**

Checked: **CHECKED**

Date: **03-15-2016**

Project Number: **PROJECT#**

Building Number: **0005**

Sheet Number:

**A-101**

Plot Date: **03-15-2016**